



EVENT ORGANISED BY  
THE 21 GUN SALUTE HERITAGE  
& CULTURAL TRUST"



# 2025 KAMDHENU GAU KRISHI MAHOTSAV

Asia's Largest Livestock & Agri Expo

## Yashobhoomi

India International Convention and  
Expo Centre (IICC), New Delhi

Associate  
Member



In  
Collaboration  
with



Member



500+ Exhibitors



20+ Event Speakers



25+ Event Sessions



30+ Sponsors & Partners



88 Indian Cow Breeds



20+ Countries



PRESENTED BY

THE INTERNATIONAL FEDERATION OF  
INDIGENOUS ZEBU CATTLE OF INDIA



Follow us for  
latest updates

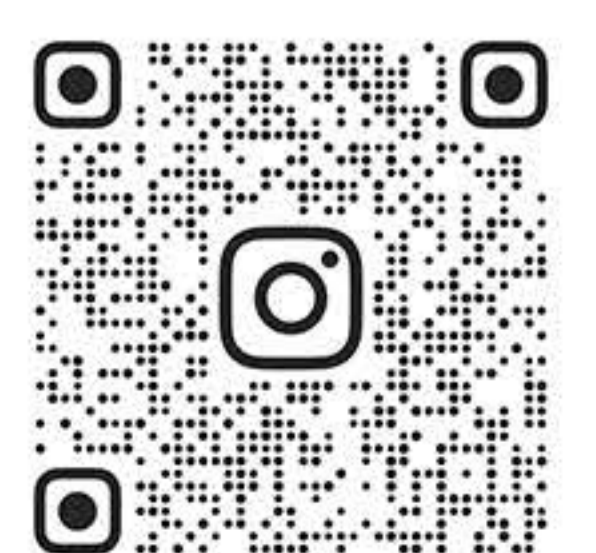

@KGKMINDIA



2025  
**KAMDHENU**  
GAU KRISHI MAHOTSAV

Organized by:  
21 Gun Salute Cultural & Heritage Trust

Asia's largest livestock & Agri Expo

## ABOUT US

 [www.kgkmindia.com](http://www.kgkmindia.com)

The Kamdhenu Gau Krishi Mahotsav (KGKM) is a one-of-a-kind event dedicated to showcasing the diversity of Indian indigenous cow breeds and promoting sustainable agricultural practices. Organized by the International Federation of Indigenous Zebu Cattle of India (IFIZCI), this event aims to facilitate all the stakeholders involved in the dairy and agriculture industries in exploring best practices, exchanging knowledge, promoting their products, and establishing a broader network of like-minded individuals in the industry, government, and academia.



88 Indigenous  
Cow Breeds of  
India



International  
Collaboration  
& Partnership



Seminars  
on best Practices and  
Advanced Technologies



Dairy Equipment  
& Products



Agriculture Equipment  
& Tractors



Traditional  
Handicrafts





**THE INTERNATIONAL FEDERATION OF INDIGENOUS ZEBU CATTLE OF INDIA**

## **ABOUT IFIZCI**

The International Federation of Indigenous Zebu Cattle of India (IFIZCI) stands as a dedicated Indian organization, placing its primary focus on the enhancement of Zebu Cattle breeds and fostering international collaboration. The objective is to preserve the best germplasm and genetics of all Indian Zebu breeds. Through the incorporation of innovative technologies, comprehensive training programs, and ongoing research on nutrition and feeding practices, IFIZCI is committed to elevating the well-being of Indigenous Zebu Cattle. We staunchly advocate policies that support the conservation of these invaluable breeds, while simultaneously facilitating income-generation opportunities for cattle breeders. Our commitment extends to the promotion of sustainable agriculture and fodder production techniques as well as the preservation of traditional cattle rearing practices.



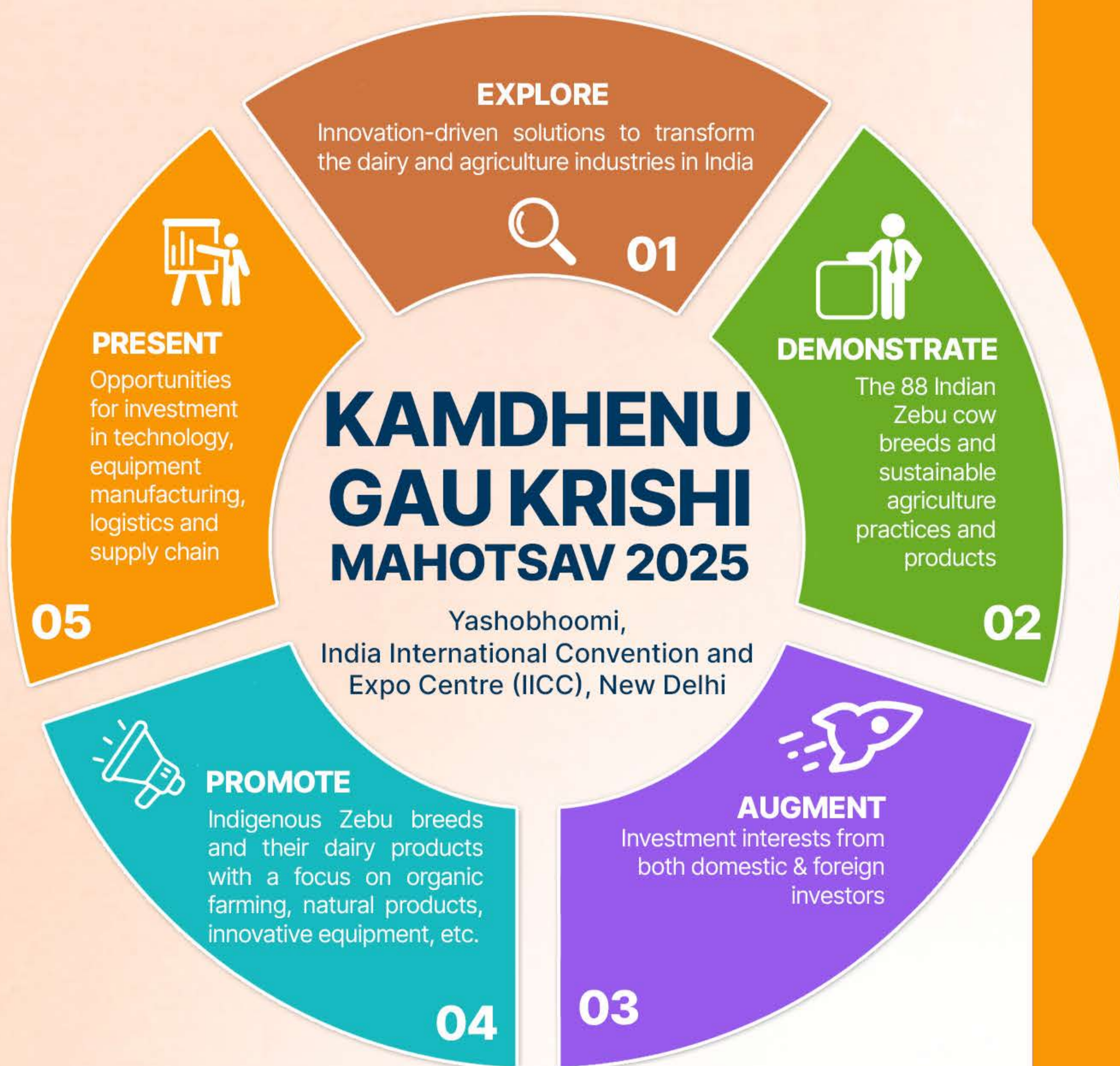

## WHO SHOULD ATTEND?

- Cow Breeding and Genetics Companies
- Cow Fodder and Nutrition Companies
- Milk Marketing Companies & Co-Operatives
- Dairy Medicine Companies
- Dairy Equipment Manufacturers
- Cow Eco-tourism Centers
- Cow Economic Products
- State Livestock Development Boards
- Gaushala Management Services
- Crop Genetics and Soil Science Companies
- Pharma Companies (Ayurvedic, Allopathic & Homeopathic)
- Fertilizer and Pesticide Manufacturers
- Tractors & Agriculture Equipments (Manufacturers and Distributors)
- Agricultural and Veterinary Universities
- Agricultural Consultants and Researchers
- Cosmetic and Household Item Producers
- Startups, Incubator Industries & Laboratories
- Banks, Micro Financers & Insurance Companies
- Media Houses
- Chamber of Commerce, State Chapters, FICCI, ASSOCHAM, NGO Forums

## WHY EXHIBIT?

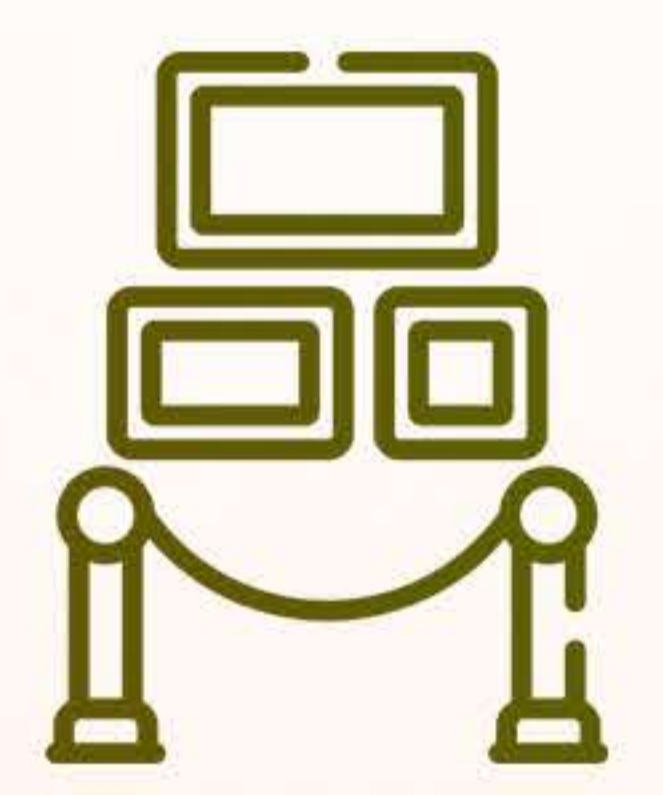









- VISIBILITY:** SHOWCASE YOUR PRODUCTS, INNOVATIONS, AND EXPERTISE TO A DIVERSE AND ENGAGED AUDIENCE.
- NETWORKING:** CONNECT WITH INDUSTRY LEADERS, PROFESSIONALS, AND GOVERNMENT REPRESENTATIVES.
- GLOBAL EXPOSURE:** GAIN VISIBILITY AMONG INTERNATIONAL PARTICIPANTS AND ORGANIZATIONS.
- KNOWLEDGE EXCHANGE:** BE PART OF DISCUSSIONS, SEMINARS, AND WORKSHOPS ON THE LATEST TRENDS AND INNOVATIONS IN THE INDUSTRY.

# EXPLORE THE BEST OF AGRI & DAIRY INDUSTRY

## Agri and Dairy Equipments

 Receiving/loadout/ transportation	 Grinding and particle size reduction
 Feed Additives and nutrition ingredients	 Packaging, Processing, Filling Machines
 Packging/Bagging equipment	 Ingredient storage
 Mixers	 Silage
 Milk collection handling & transport	 Breeding/AI & Equipment
 Milk Processing Plants	 Forage Harvester
 Milking Machines	 Cattle Feed Companies

## Agri Related Industries

 Agro Chemicals and Fertilizers	 Seeds and Crop Protection
 Organic and Sustainable Agriculture	 Horticulture and Floriculture
 Agribusiness Services	 Soil Testing & Analysis
 Greenhouse Technology	 Agricultural Research Institutions

## Laboratory Products & Services

 Feed testing	 Laboratory products
 Disease testing	 Fermentation products
 AI Insemination	 Breeding/genetics

## Health Products

 Vaccines	 Monitoring solutions
 Growth promoters/ therapeutic agents	 Remote animal welfare



Vitamins





## Different Stake Holders

 State/Central Govt	 Associations
 Banks Financial Institutions Insurance Companies	 Export Promotion Bodies



NGOs

## Feed Ingredients General Facility Items

 Boiler/ steam systems	 Refrigeration & coolants
 Waste handling	 Sanitation & cleaning products



Lighting



# CATTLE GENETIC RESOURCES



AMRITMAHAL



PUNGANUR



BACHAUR



DANGI



BARGUR



KHERIGARH



DEONI



ONGOLE (Nellori)



GAOLAO



KRISHNA VALLEY



HALLIKAR



RED SINDHI



KANKREJ



RED KHANDHARI



KENKATHA



SIRI



MALVI



UMLBACHERY



THARPARKAR



NAGORI



NIMARI



THUTHO



SWETA KAPILA



PONWAR



VECHAR



GHUMUSARI



KHARIAR



KOSALI



PURNEA



KATHANI



RATHI



MOTU



BINJHARPURI



PULIKULAM



BELAHI



SANCHORI



HIMACHALI PAHARI



GIR



GANGATIRI



KANGAYAM



BADRI



HARIANA



LADAKHI



MASILUM



LAKHIMI



KHILLAR



KONKAN KAPILA



SAHIWAL



PODA THURPU



MALNAD GIDDA



NARI



MEWATI



DAGRI

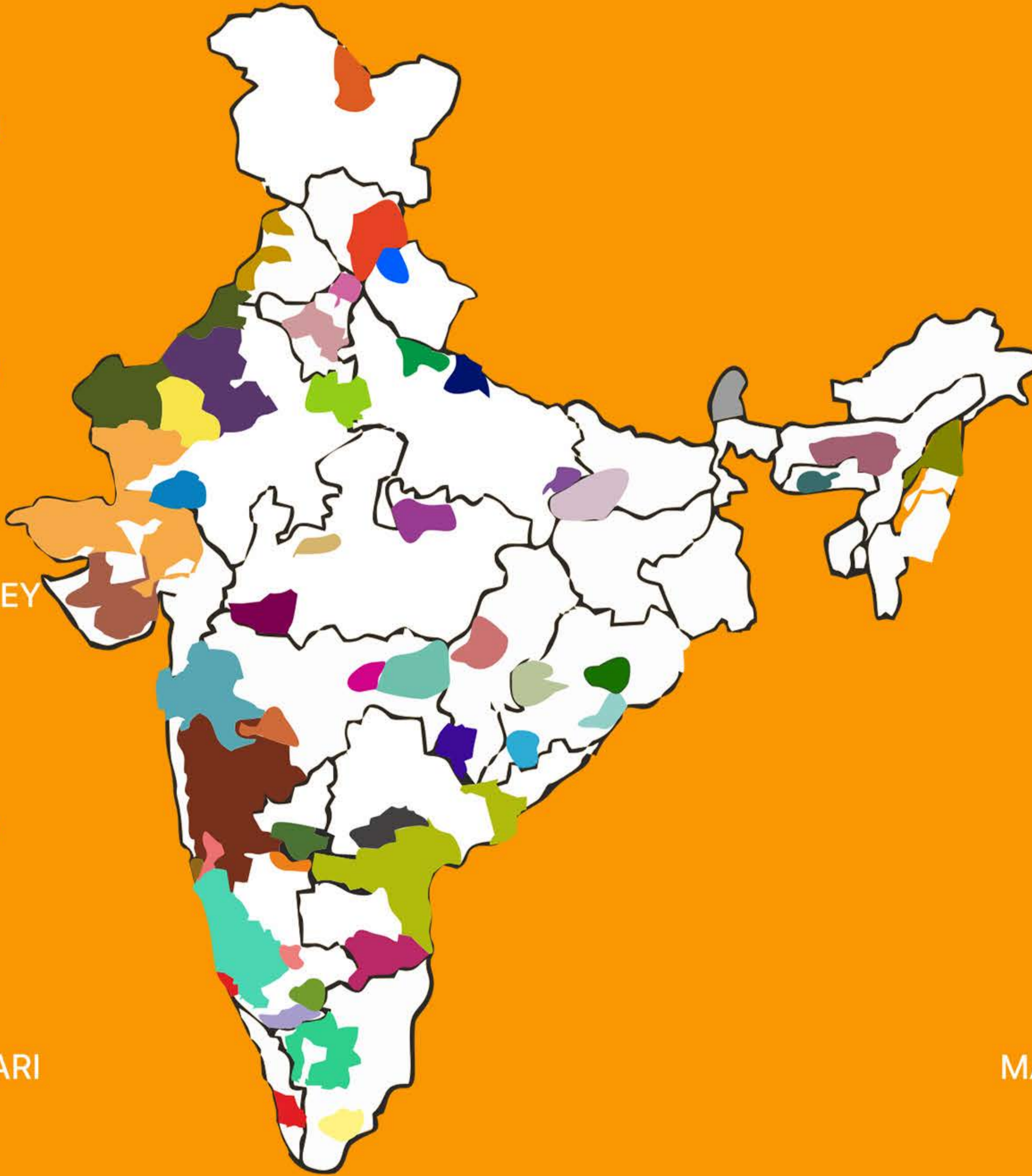

Cow colour coding according to their respective region



# INDIGENIOUS COW BASED ECONOMY

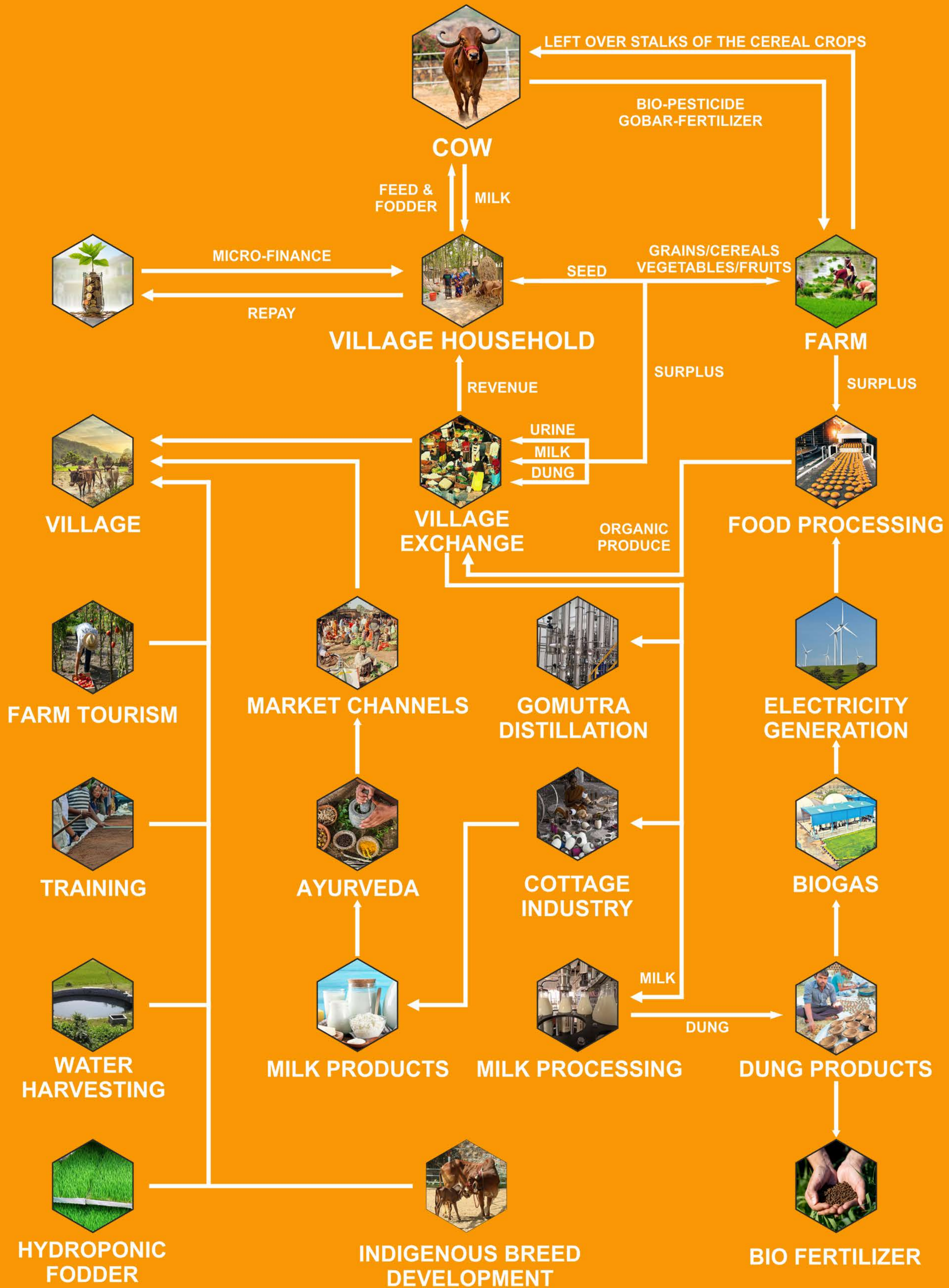

## ECHOES FROM THE PAST: THE ZEBU BULL'S ENDURING LEGACY SINCE THE HARAPPAN CIVILIZATION



**SOURCE - THE BULL SEAL IS CURRENTLY ON DISPLAY AT THE HARAPPA MUSEUM IN PAKISTAN**

Step back in time to the sacred realm of the ancient Indus Valley Civilization, where the cow has held sanctity since time immemorial. Unearthed from the layers of history, the Bull Seal, dating back to approximately 2200-2500 BCE, is a poignant relic from 'The Indus Valley Civilization,' flourishing between 3300 to 1300 BCE.

This small yet significant artifact, crafted from steatite, showcases an intricately carved image of a bull with a majestic hump and curving horns. Standing on a pedestal, the bull is encircled by a border of symbols within the seal - a testament to the profound significance of cattle in this ancient Indian civilization. Theories surrounding the purpose of the Bull Seal vary; some suggest its use as a stamp or seal, possibly indicating ownership of goods or documents, while others point to its integral role in religious rituals.

Its thematic recurrence in rituals and decorative arts has captivated archaeologists, portraying 'The Humped Bull' as a compelling subject. This emblematic figure, appearing on painted pottery and as figurines, predates the rise of cities and persists into later historical times.

Symbolizing strength, virility, and leadership within the herd, the Zebu Bull potentially served as the guardian ensuring the procreation of the species. Carved in stone, it may represent the most powerful clans or top officials of Mohenjo-daro and Harappa. As we explore the echoes of this ancient civilization, the Zebu Bull stands as a timeless symbol, resonating with the cultural and historical richness of the region.



# RADIANT REVELRY: INDIA'S PREMIER CATTLE CELEBRATIONS

COWS HAVE BEEN AN INTEGRAL PART OF ALL OUR FESTIVALS AND CELEBRATIONS

सर्वदेवनमस्कारः केशवं प्रतिगच्छति ।  
कुर्वञ्नेवार्चितं भूयः सुर्पूजा भवेत्ततः ।

"All gods and goddesses are present in the body of the cow. Worshipping the cow is equivalent to worshipping Lord Krishna. Performing cow worship leads to the highest form of divine worship."



## POLA

Celebrated in Maharashtra & Chattisgarh, this festival highlights the importance of cows by acknowledging their crucial part in agriculture and farming activities.

## GOREHABBA

Gorehabba or Gore Habba is a festival of splashing cow dung on each other. It is celebrated as 'Thanksgiving' by farmers in Gumatapura, Karnataka.



## Go Bandna

A post-harvesting celebration called Go Bandna, or the festival of the cow. In Bengali, 'go' means cow and 'bandna' means worship. Celebrated by the Santals of Purulia as 'Thanksgiving' to the cows, they offer special baths to their cows. Perform the songs of go-jagania, which protect their cattle from the evil forces of the night accompanied by painting, dancing, music, food and sports.



## GAIJATRA

Celebrated in the Indo-Gangetic Plain. Cows are marched on the streets in the memory of family members who have passed away. The name roughly translates to Cow's Journey!





## JALLIKATTU

A traditional event of Tamil Nadu where a bull is released into a crowd & multiple participants attempt to grab the bull's hump on the back with arms & hang on to it while the bull attempts to escape.

## KHEKRA FESTIVAL

An old tradition performed to worship cows on Govardhan Puja in Nathdwara. Cows' heads are embellished with peacock feathers & their necks are belled. Furthermore cows are ornamented with ghunguroos in their legs and vibrantly painted horns.



## MOICHARA

The speciality of Moichara lies in the manner it is celebrated, which is marked by cattle race among villagers. This festival is over 100 years old & the primary purpose is to test the capacity of the bulls before the start of cultivation and increase the fertility of the land.

## BIHU

1st day of Bwisagu is dedicated to cow worship by the Bodos of Assam. Cows are bathed, decorated with garlands, their horns are oiled & turmeric paste on their foreheads.



## KICCHU HAYISUVUDU

Famous in Mysuru and Mandya, cattle are made to walk through fire to celebrate the festival of harvest. The ritual involves bullocks and their masters running through the flames for warding off evil & bringing good luck to them.





## GOVATSA DWADASHI

Govatsa Dwadashi is also celebrated as Nandi Vrat. Nandi is the divine cow in Hinduism who is worshipped on this day. Post worship, they are given food made from wheat. The use of cow's milk & wheat products is prohibited on this day.

## PASUVULA PANDUGA CATTLE FESTIVAL

This cattle festival in Andhra Pradesh is observed to appease the gods for improving & protecting livestock. Cows & bulls are colourfully decorated with trophies attached to their horns to be snatched by the villagers.



## NAGAUR CATTLE FESTIVAL

This Cattle Festival is held in the quaint town of Nagaur. Essentially fun events like tug-of-war, camel & bullock races take place along with enchanting folk music of Jodhpur.

## DEEPALI TIHAR

Cows are worshipped as the vahana (vehicle) of Goddess Lakshmi associated with prosperity. Women show their gratitude to the cow by doing their Aarti & Tikka & feeding them prasad.



## kambala Festival





## KEY HIGHLIGHTS

- Vintage Tractor Drive & Display
- Cow Genetics and Breed Improvement
- Agricultural Equipments and Allied Industries
- Traditional & Modern Cattle Rearing Practices
- Dairy Products, Milk Plants & Machines
- Crop Genetics & Soil Science
- Pharma Companies ( Ayurvedic, Allopathic & Homeopathic)
- Traditional Art & Handicraft
- Showcase of Ancient Indian Dairy & Agricultural Equipment Museum through immersive 3D models

**Experience the Majesty of India's Sacred Cattle & Agricultural Heritage**

## EXHIBIT AT KGKM

Types of Spaces	Area	Participation Charges (per sq. m)*	
		INR	USD
Indoor Area Stalls	9 M <sup>2</sup> , 12 M <sup>2</sup> , 15 M <sup>2</sup> , 18 M <sup>2</sup> & above as per requirement	12000*	150
Foyer Area Stalls	25 M <sup>2</sup> , 30 M <sup>2</sup> , 36 M <sup>2</sup> & above as per requirement	8000*	100
NGO & FPO Open Area	9 M <sup>2</sup> , 12 M <sup>2</sup> , 15 M <sup>2</sup> , 18 M <sup>2</sup> & above as per requirement	4000*	50

*\*All charges are exclusive of applicable GST.*

*\*Inaugural discount on the first come first serve basis.*

**BOOK NOW!**



Scan to know  
more about the event

[www.kgkmindia.com](http://www.kgkmindia.com)



## SPONSORSHIP PACKAGES

We are delighted to offer a range of sponsorship opportunities designed to maximize your company's exposure and engagement at the event:

	75 Lacs	50 Lacs	35 Lacs	25 Lacs	15 Lacs	10 Lacs	5 Lacs
	1	2	3	4	5	6	7
	TITLE	DIAMOND	PLATINUM	GOLD	SILVER	BRONZE	LANYARD
<b>Booth space (Shell/Raw Space)</b>	100 sq. mt /125 sq.mt.	60 sq. mt /75 sq.mt.	45 sq. mt /36 sq.mt	36 sq. mt /27 sq.mt	27 sq. mt /18 sq.mt	18 sq. mt /12 sq.mt	9 sq. mt
<b>Branding in promotional material (Banners, posters, hoardings, newspaper, Website, etc.)</b>	✓	✓	✓	✓	✓	✓	
<b>Company Profile in Website</b>	✓	✓	✓	✓	✓	✓	✓
<b>Company logo in official brochure</b>	✓	✓	✓	✓	✓	✓	
<b>Social Media Promotions</b>	✓	✓	✓	✓	✓	✓	
<b>Colour Advertisement in Fair Catalogue</b>	✓	✓	✓	✓	✓	✓	✓
<b>Colour Advertisement in Official Newspaper of KGKM</b>	✓	✓	✓	✓	✓	✓	✓
<b>Banners at venue</b>	✓	✓	✓	✓	✓	✓	✓
<b>Keynote Speakership</b>	✓	✓	✓	✓	✓		
<b>Group Discussions</b>	✓	✓	✓	✓	✓	✓	



Yashobhoomi  
India International Convention and  
Expo Centre (IICC), New Delhi

**IIEC DWARKA**  
**EXHIBITION HALL 2 PLAN**

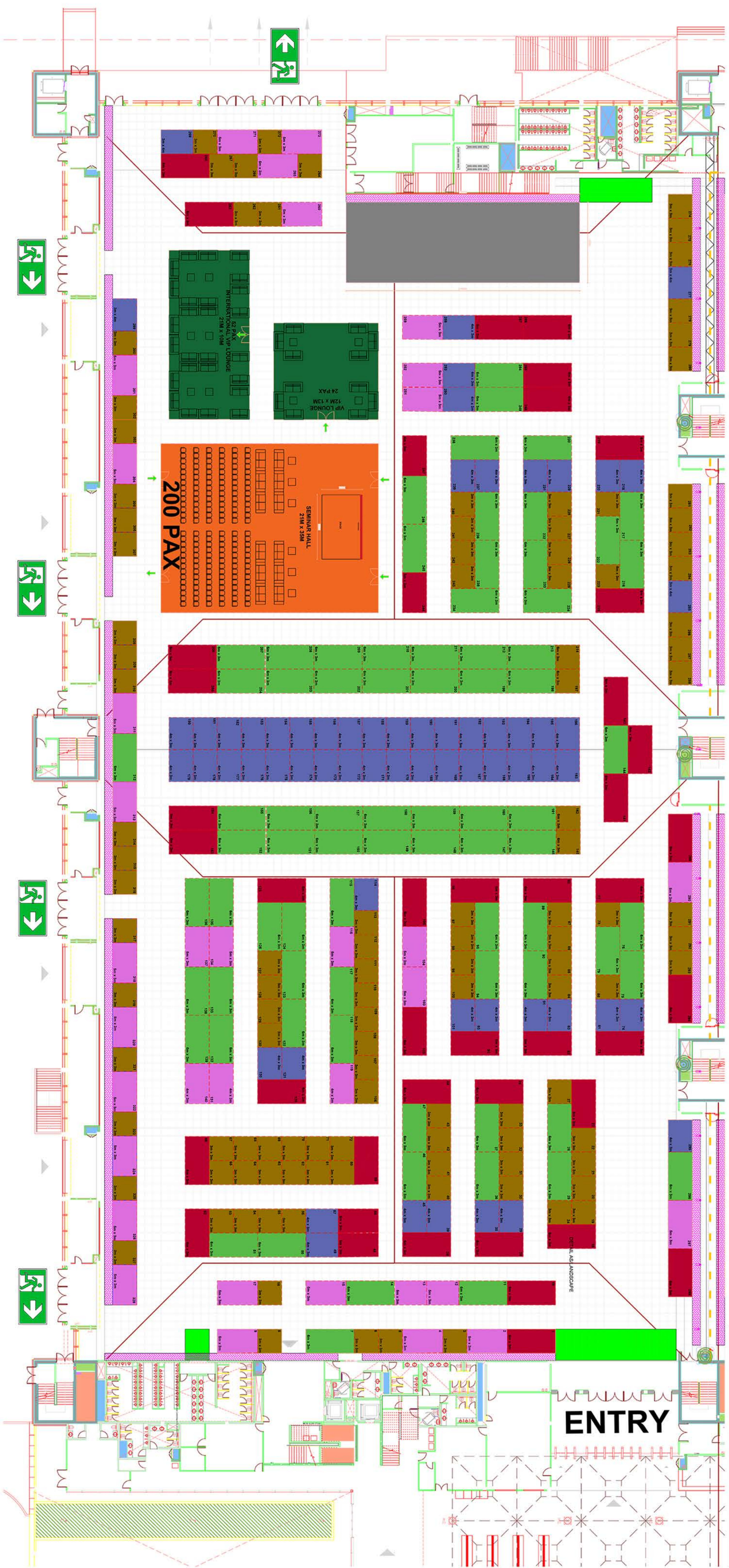

LEGENDS		
	3m x 3m	112 Nos.
	4m x 3m	63 Nos.
	5m x 3m	34 Nos.
	6m x 3m	101 Nos.
	6m x 3m	PRIME
TOTAL STALLS - 328 Nos.		

**Client / Employer**

Ministry of Urban Infrastructure & Development  
 Government of India  
 Directorate of Urban Infrastructure & Development  
 Government of India

**Project Name**

INTERNATIONAL CONVENTION & EXHIBITION CENTRE  
 SECTOR 25, DWARKA, NEW DELHI, INDIA

**Contractor**

L&T Construction  
 L&T Infrastructure Development Limited  
 Plot No. 10, Sector 25, Dwarka, New Delhi-110046, India

**Design Consultant**

CR  
 CR Consultants (India) Private Limited  
 Plot No. 10, Sector 25, Dwarka, New Delhi-110046, India

**Structural Consultant**

ACCP  
 ACCP Associates Pvt. Ltd.  
 Plot No. 10, Sector 25, Dwarka, New Delhi-110046, India

**M&E Consultant**

IGES  
 Iqbal Engineers & Architects Pvt. Ltd.  
 Plot No. 10, Sector 25, Dwarka, New Delhi-110046, India

**Electrical Consultant**

CR  
 CR Consultants (India) Private Limited  
 Plot No. 10, Sector 25, Dwarka, New Delhi-110046, India

**Architectural Consultant**

CR  
 CR Consultants (India) Private Limited  
 Plot No. 10, Sector 25, Dwarka, New Delhi-110046, India

**Project Engineer**

MEP  
 MEP Consultants (India) Private Limited  
 Plot No. 10, Sector 25, Dwarka, New Delhi-110046, India

**Scale**

AS SHOWN

**Revision**

NO. 0001 CONNECTIONS  
 NO. 0002 ELECTRICAL  
 NO. 0003 CIVIL  
 NO. 0004 LANDSCAPE FINISHES

**Project Name**

INTERNATIONAL CONVENTION & EXHIBITION CENTRE  
 SECTOR 25, DWARKA, NEW DELHI, INDIA

**Contractor**

L&T Construction  
 L&T Infrastructure Development Limited  
 Plot No. 10, Sector 25, Dwarka, New Delhi-110046, India

**Design Consultant**

CR  
 CR Consultants (India) Private Limited  
 Plot No. 10, Sector 25, Dwarka, New Delhi-110046, India

**Structural Consultant**

ACCP  
 ACCP Associates Pvt. Ltd.  
 Plot No. 10, Sector 25, Dwarka, New Delhi-110046, India

**M&E Consultant**

IGES  
 Iqbal Engineers & Architects Pvt. Ltd.  
 Plot No. 10, Sector 25, Dwarka, New Delhi-110046, India

**Electrical Consultant**

CR  
 CR Consultants (India) Private Limited  
 Plot No. 10, Sector 25, Dwarka, New Delhi-110046, India

**Architectural Consultant**

CR  
 CR Consultants (India) Private Limited  
 Plot No. 10, Sector 25, Dwarka, New Delhi-110046, India

**Project Engineer**

MEP  
 MEP Consultants (India) Private Limited  
 Plot No. 10, Sector 25, Dwarka, New Delhi-110046, India

**Scale**

AS SHOWN

**Revision**

NO. 0001 CONNECTIONS  
 NO. 0002 ELECTRICAL  
 NO. 0003 CIVIL  
 NO. 0004 LANDSCAPE FINISHES



**Key Plan**

Location map showing the project site within Sector 25, Dwarka, New Delhi.

**Legend**

- METRO LINE  
 - PHASE 1 LINE  
 - PHASE 2 LINE  
 - BASEMENT LINE

**ABBREVIATIONS**

1. ALL DIMENSIONS ARE IN METRES, UNLESS SPECIFIED OTHERWISE.
2. ALL DIMENSIONS TO BE CHECKED AGAINST THE ORIGINAL DRAWINGS.
3. ALL DIMENSIONS SHALL BE TAKEN FROM THE CENTER OF THE ROAD.
4. ALL DIMENSIONS SHALL BE TAKEN FROM THE CENTER OF THE ROAD.
5. ALL DIMENSIONS SHALL BE TAKEN FROM THE CENTER OF THE ROAD.
6. ALL DIMENSIONS SHALL BE TAKEN FROM THE CENTER OF THE ROAD.
7. ALL DIMENSIONS SHALL BE TAKEN FROM THE CENTER OF THE ROAD.
8. ALL DIMENSIONS SHALL BE TAKEN FROM THE CENTER OF THE ROAD.
9. ALL DIMENSIONS SHALL BE TAKEN FROM THE CENTER OF THE ROAD.
10. ALL DIMENSIONS SHALL BE TAKEN FROM THE CENTER OF THE ROAD.
11. ALL DIMENSIONS SHALL BE TAKEN FROM THE CENTER OF THE ROAD.

**SYMBOL LEGEND**

SYMBOL	DESCRIPTION
(Symbol)	DOUBLE CURVED LIGHT COLUMN POLES (B&W)
(Symbol)	SINGLE CURVED LIGHT COLUMN POLES (B&W)
(Symbol)	RAIN WATER HARVESTING PIT
(Symbol)	ELECTRICAL SYMBOL
(Symbol)	BEELIGHTING CODE LA.05.05
(Symbol)	SOLAR FCU PANEL
(Symbol)	FEDERATION LIGHT COLUMN
(Symbol)	COMPOUND WALL LIGHT
(Symbol)	SCOT DRAIN
(Symbol)	YARD DRAIN
(Symbol)	WATER VALVE
(Symbol)	ALARM VALVE
(Symbol)	FREE BRIGADE INLET
(Symbol)	STORM MANHOLES
(Symbol)	SPRINKLER MANHOLES
(Symbol)	CATCH PITS
(Symbol)	GULLY TRAP
(Symbol)	SACKER DRAIN
(Symbol)	SCOT DRAIN

**LEGEND**

CODE	COLOR	MATERIAL	DESCRIPTION
LA.01.01	(Color)	WHITE GRANITE	TYPE 1 - GRANITE (B&W)
LA.01.02	(Color)	WHITE GRANITE	TYPE 2 - GRANITE (B&W)
LA.01.03	(Color)	WHITE GRANITE	TYPE 3 - GRANITE (B&W)
LA.01.04	(Color)	WHITE GRANITE	TYPE 4 - GRANITE (B&W)
LA.01.05	(Color)	WHITE GRANITE	TYPE 5 - GRANITE (B&W)
LA.01.06	(Color)	WHITE GRANITE	TYPE 6 - GRANITE (B&W)
LA.01.07	(Color)	WHITE GRANITE	TYPE 7 - GRANITE (B&W)
LA.01.08	(Color)	WHITE GRANITE	TYPE 8 - GRANITE (B&W)
LA.01.09	(Color)	WHITE GRANITE	TYPE 9 - GRANITE (B&W)
LA.01.10	(Color)	WHITE GRANITE	TYPE 10 - GRANITE (B&W)
LA.01.11	(Color)	WHITE GRANITE	TYPE 11 - GRANITE (B&W)
LA.01.12	(Color)	WHITE GRANITE	TYPE 12 - GRANITE (B&W)
LA.01.13	(Color)	WHITE GRANITE	TYPE 13 - GRANITE (B&W)
LA.01.14	(Color)	WHITE GRANITE	TYPE 14 - GRANITE (B&W)
LA.01.15	(Color)	WHITE GRANITE	TYPE 15 - GRANITE (B&W)
LA.01.16	(Color)	WHITE GRANITE	TYPE 16 - GRANITE (B&W)
LA.01.17	(Color)	WHITE GRANITE	TYPE 17 - GRANITE (B&W)
LA.01.18	(Color)	WHITE GRANITE	TYPE 18 - GRANITE (B&W)
LA.01.19	(Color)	WHITE GRANITE	TYPE 19 - GRANITE (B&W)
LA.01.20	(Color)	WHITE GRANITE	TYPE 20 - GRANITE (B&W)
LA.01.21	(Color)	WHITE GRANITE	TYPE 21 - GRANITE (B&W)
LA.01.22	(Color)	WHITE GRANITE	TYPE 22 - GRANITE (B&W)
LA.01.23	(Color)	WHITE GRANITE	TYPE 23 - GRANITE (B&W)
LA.01.24	(Color)	WHITE GRANITE	TYPE 24 - GRANITE (B&W)
LA.01.25	(Color)	WHITE GRANITE	TYPE 25 - GRANITE (B&W)
LA.01.26	(Color)	WHITE GRANITE	TYPE 26 - GRANITE (B&W)
LA.01.27	(Color)	WHITE GRANITE	TYPE 27 - GRANITE (B&W)
LA.01.28	(Color)	WHITE GRANITE	TYPE 28 - GRANITE (B&W)
LA.01.29	(Color)	WHITE GRANITE	TYPE 29 - GRANITE (B&W)
LA.01.30	(Color)	WHITE GRANITE	TYPE 30 - GRANITE (B&W)
LA.01.31	(Color)	WHITE GRANITE	TYPE 31 - GRANITE (B&W)
LA.01.32	(Color)	WHITE GRANITE	TYPE 32 - GRANITE (B&W)
LA.01.33	(Color)	WHITE GRANITE	TYPE 33 - GRANITE (B&W)
LA.01.34	(Color)	WHITE GRANITE	TYPE 34 - GRANITE (B&W)
LA.01.35	(Color)	WHITE GRANITE	TYPE 35 - GRANITE (B&W)
LA.01.36	(Color)	WHITE GRANITE	TYPE 36 - GRANITE (B&W)
LA.01.37	(Color)	WHITE GRANITE	TYPE 37 - GRANITE (B&W)
LA.01.38	(Color)	WHITE GRANITE	TYPE 38 - GRANITE (B&W)
LA.01.39	(Color)	WHITE GRANITE	TYPE 39 - GRANITE (B&W)
LA.01.40	(Color)	WHITE GRANITE	TYPE 40 - GRANITE (B&W)
LA.01.41	(Color)	WHITE GRANITE	TYPE 41 - GRANITE (B&W)
LA.01.42	(Color)	WHITE GRANITE	TYPE 42 - GRANITE (B&W)
LA.01.43	(Color)	WHITE GRANITE	TYPE 43 - GRANITE (B&W)
LA.01.44	(Color)	WHITE GRANITE	TYPE 44 - GRANITE (B&W)
LA.01.45	(Color)	WHITE GRANITE	TYPE 45 - GRANITE (B&W)
LA.01.46	(Color)	WHITE GRANITE	TYPE 46 - GRANITE (B&W)
LA.01.47	(Color)	WHITE GRANITE	TYPE 47 - GRANITE (B&W)
LA.01.48	(Color)	WHITE GRANITE	TYPE 48 - GRANITE (B&W)
LA.01.49	(Color)	WHITE GRANITE	TYPE 49 - GRANITE (B&W)
LA.01.50	(Color)	WHITE GRANITE	TYPE 50 - GRANITE (B&W)
LA.01.51	(Color)	WHITE GRANITE	TYPE 51 - GRANITE (B&W)
LA.01.52	(Color)	WHITE GRANITE	TYPE 52 - GRANITE (B&W)
LA.01.53	(Color)	WHITE GRANITE	TYPE 53 - GRANITE (B&W)
LA.01.54	(Color)	WHITE GRANITE	TYPE 54 - GRANITE (B&W)
LA.01.55	(Color)	WHITE GRANITE	TYPE 55 - GRANITE (B&W)
LA.01.56	(Color)	WHITE GRANITE	TYPE 56 - GRANITE (B&W)
LA.01.57	(Color)	WHITE GRANITE	TYPE 57 - GRANITE (B&W)
LA.01.58	(Color)	WHITE GRANITE	TYPE 58 - GRANITE (B&W)
LA.01.59	(Color)	WHITE GRANITE	TYPE 59 - GRANITE (B&W)
LA.01.60	(Color)	WHITE GRANITE	TYPE 60 - GRANITE (B&W)
LA.01.61	(Color)	WHITE GRANITE	TYPE 61 - GRANITE (B&W)
LA.01.62	(Color)	WHITE GRANITE	TYPE 62 - GRANITE (B&W)
LA.01.63	(Color)	WHITE GRANITE	TYPE 63 - GRANITE (B&W)
LA.01.64	(Color)	WHITE GRANITE	TYPE 64 - GRANITE (B&W)
LA.01.65	(Color)	WHITE GRANITE	TYPE 65 - GRANITE (B&W)
LA.01.66	(Color)	WHITE GRANITE	TYPE 66 - GRANITE (B&W)
LA.01.67	(Color)	WHITE GRANITE	TYPE 67 - GRANITE (B&W)
LA.01.68	(Color)	WHITE GRANITE	TYPE 68 - GRANITE (B&W)
LA.01.69	(Color)	WHITE GRANITE	TYPE 69 - GRANITE (B&W)
LA.01.70	(Color)	WHITE GRANITE	TYPE 70 - GRANITE (B&W)
LA.01.71	(Color)	WHITE GRANITE	TYPE 71 - GRANITE (B&W)
LA.01.72	(Color)	WHITE GRANITE	TYPE 72 - GRANITE (B&W)
LA.01.73	(Color)	WHITE GRANITE	TYPE 73 - GRANITE (B&W)
LA.01.74	(Color)	WHITE GRANITE	TYPE 74 - GRANITE (B&W)
LA.01.75	(Color)	WHITE GRANITE	TYPE 75 - GRANITE (B&W)
LA.01.76	(Color)	WHITE GRANITE	TYPE 76 - GRANITE (B&W)
LA.01.77	(Color)	WHITE GRANITE	TYPE 77 - GRANITE (B&W)
LA.01.78	(Color)	WHITE GRANITE	TYPE 78 - GRANITE (B&W)
LA.01.79	(Color)	WHITE GRANITE	TYPE 79 - GRANITE (B&W)
LA.01.80	(Color)	WHITE GRANITE	TYPE 80 - GRANITE (B&W)
LA.01.81	(Color)	WHITE GRANITE	TYPE 81 - GRANITE (B&W)
LA.01.82	(Color)	WHITE GRANITE	TYPE 82 - GRANITE (B&W)
LA.01.83	(Color)	WHITE GRANITE	TYPE 83 - GRANITE (B&W)
LA.01.84	(Color)	WHITE GRANITE	TYPE 84 - GRANITE (B&W)
LA.01.85	(Color)	WHITE GRANITE	TYPE 85 - GRANITE (B&W)
LA.01.86	(Color)	WHITE GRANITE	TYPE 86 - GRANITE (B&W)
LA.01.87	(Color)	WHITE GRANITE	TYPE 87 - GRANITE (B&W)
LA.01.88	(Color)	WHITE GRANITE	TYPE 88 - GRANITE (B&W)
LA.01.89	(Color)	WHITE GRANITE	TYPE 89 - GRANITE (B&W)
LA.01.90	(Color)	WHITE GRANITE	TYPE 90 - GRANITE (B&W)
LA.01.91	(Color)	WHITE GRANITE	TYPE 91 - GRANITE (B&W)
LA.01.92	(Color)	WHITE GRANITE	TYPE 92 - GRANITE (B&W)
LA.01.93	(Color)	WHITE GRANITE	TYPE 93 - GRANITE (B&W)
LA.01.94	(Color)	WHITE GRANITE	TYPE 94 - GRANITE (B&W)
LA.01.95	(Color)	WHITE GRANITE	TYPE 95 - GRANITE (B&W)
LA.01.96	(Color)	WHITE GRANITE	TYPE 96 - GRANITE (B&W)
LA.01.97	(Color)	WHITE GRANITE	TYPE 97 - GRANITE (B&W)
LA.01.98	(Color)	WHITE GRANITE	TYPE 98 - GRANITE (B&W)
LA.01.99	(Color)	WHITE GRANITE	TYPE 99 - GRANITE (B&W)
LA.01.100	(Color)	WHITE GRANITE	TYPE 100 - GRANITE (B&W)



Scan to know more about the event



[www.kgkmindia.com](http://www.kgkmindia.com)



**500+**

TOTAL EXHIBITORS



**20+**

EVENT SPEAKERS



**25+**

EVENT SESSIONS



**30+**

SPONSORS & PARTNERS



VINTAGE TRACTOR DRIVE & DISPLAY



[info@kamdhenugaukrishimahotsav.com](mailto:info@kamdhenugaukrishimahotsav.com)

@kgkmindia



© +91 9599222348

[info@kamdhenugaukrishimahotsav.com](mailto:info@kamdhenugaukrishimahotsav.com)

@kgkmindia     